

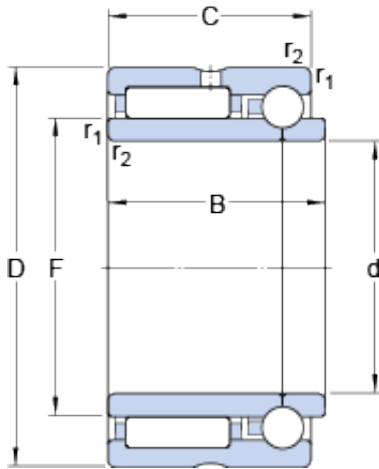

Lamar parts manufacturing company



70 mm x 100 mm x 45 mm SKF NKIB 5914 cylindrical roller bearings

Bearing No. NKIB 5914

NKIB 5914 Bearing 2D drawings and 3D CAD models

Size	100x70x45 mm
Bore Diameter	100 mm
Outer Diameter	70 mm
Width	45 mm
d	70 mm
D	100 mm
B	45 mm
C	40 mm
F	80 mm
$r_{1,2}$ - min.	1 mm
d_a - min.	75 mm
D_a - max.	95 mm
r_a - max.	1 mm
Basic dynamic load rating, radial direction - C	84.2 kN
Basic static load rating, radial direction - C_0	163 kN
Basic dynamic load rating, axial direction - C	13.2 kN
Basic static load rating, axial direction - C_0	25 kN
Fatigue load limit, radial direction - P_u	20.8 kN
Fatigue load limit, axial direction - P_u	1 kN
Reference speed	5000 r/min
Limiting speed	5600 r/min



Lamar parts manufacturing company

Category	Roller Bearings
Inventory	0.0
Manufacturer Name	SKF
Minimum Buy Quantity	N/A
Weight / Kilogram	1.063
Product Group	B04144
$r_{1,2}$ min.	1 mm
d_a min.	75 mm
D_a max.	95 mm
r_a max.	1 mm
Basic dynamic load rating, radial direction C	84.2 kN
Basic static load rating, radial direction C_0	163 kN
Basic dynamic load rating, axial direction C	13.2 kN
Basic static load rating, axial direction C_0	25 kN
Fatigue load limit, radial direction P_u	20.8 kN
Fatigue load limit, axial direction P_u	1.05 kN
Mass bearing	0.98 kg