

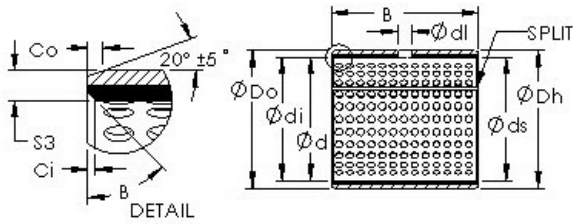

Lamar parts manufacturing company

AST AST20 32IB32 plain bearings



Bearing No. AST20 32IB32

Bore Diameter	50,8 mm
Outer Diameter	55,5752 mm
Bearing Type	straight
Shaft Dia., Nominal (d)	2.0000
Shaft Size (ds)	1.9881 / 1.9863
Housing Bore Dia. (Dh)	2.1887 / 2.1875
Bearing Outside Diameter, Nominal(Do)	2.188
Bearing Bore after Mounting (di)	1.9963 / 1.9915
Average Clearance (Cd)	0.0070
Wall Thickness (S3)	0.098
Bearing Length, Nominal (B)	2.000
Bearing Length Tolerance (B tol.) - +.010 / -0.010	+0.010 / 0.010
OD Chamfer Length (Co)	0.070
ID Chamfer Angle (B deg.)	45
ID Chamfer Length (Ci)	0.031
Lube Hole Dia. (dl)	0.313
Material	Carbon steel shell with POM plastic liner

AST20 32IB32 Bearing 2D drawings and 3D CAD models