

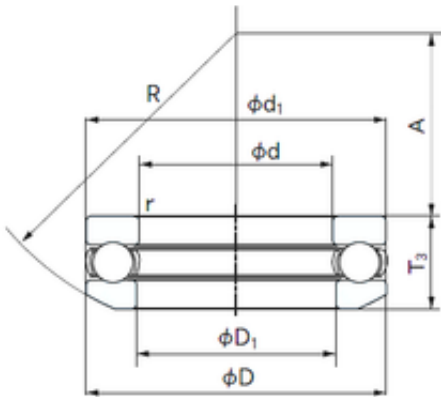

Lamar parts manufacturing company

NACHI 53326 thrust ball bearings

Bearing No. 53326



53326 Bearing 2D drawings and 3D CAD models

Size	130x225x80.3 mm
Bore Diameter	130 mm
Outer Diameter	225 mm
Width	80.3 mm
d	130 mm
D	225 mm
T	80.3 mm
d1	220 mm
r min.	2.1 mm
A	53 mm
D1	134 mm
R	160 mm
Weight	12.6 Kg
Basic dynamic load rating (C)	330 kN
Basic static load rating (C0)	960 kN
(Grease) Lubrication Speed	730 r/min